

MCCLELLAN JET SERVICES

AIRFIELD BUILDING

BUILDING

733

A3,A4,A5



**4901 KILZER AVENUE
MCCLELLAN, CA 95652**

AIRPORT LOCATION: WEST

BUILDING FEATURES:

TOTAL BUILDING: 12,745 SF
EACH HANGAR: 4,140 SF

- CLEAR SPAN: 69'
 - AFFF FOAM: NO
 - BUILDING SIGNAGE OPPORTUNITY
 - AMPLE PARKING: 1:1,000
 - ON-SITE SECURITY
 - CLOSE PROXIMITY TO WATT & I-80 FREEWAYS
 - FULL BROKER COOPERATION
- RUNWAY TO RICHES INCENTIVE PROGRAM



LOCAL AMENITIES:

- FULL SERVICE AIRPORT AND FBO
- FULL SERVICE HOTEL & CONFERENCE CENTER
- MCCLELLAN FACILITY SERVICES (AVAILABLE FOR CONTRACT)
- ONSITE RESTAURANTS
- REGIONAL TRANSIT SHUTTLE TO LIGHTRAIL



McClellan
Jet Services 

FOR MORE INFORMATION: 916.641.8970

MCCLELLAN JET SERVICES

FLOOR PLAN & LOCATION

BUILDING

733

A3,A4,A5

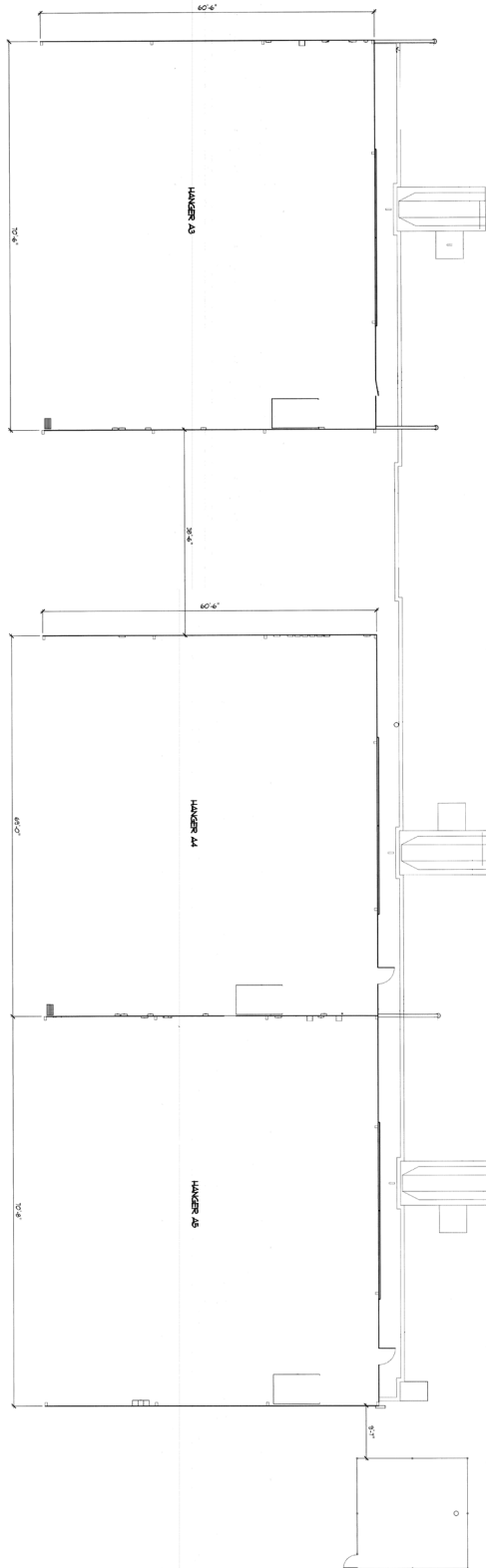

**4901 KILZER AVENUE
MCCLELLAN, CA 95652**

**FROM WINTERS STREET
NORTH:**

- › RIGHT ON DUDLEY BLVD
- › LEFT ON FORCUM AVENUE
- › ENTER THROUGH GATE 31

**COME TO
4901 KILZER AVENUE**

*NOTE: PRIOR AUTHORIZATION MUST BE
GRANTED TO GAIN ACCESS TO AIRFIELD

**MCCLELLAN PARK IS LOCATED
WITHIN MINUTES OF LOCAL
FREEWAYS.**

**RT PROVIDES TRANSIT
THAT LINKS YOU FROM THE
PARK TO THE LOCAL LIGHTRAIL.**

CONTACT:

SCOTT OWENS

916.570.5355

INFO@MCCLELLANJETSERVICES.COM

WWW.MCCLELLANJETSERVICES.COM